



alcatel 2020

For more information on how to use the phone, please go to www.alcatelmobile.com and download the complete user manual. Moreover, on the website, you can also find answers to frequently asked questions and so much more.

Table of contents

1	Getting started	5
1.1	Set up	5
1.2	Power on your phone	10
1.3	Power off your phone.....	10
2	Your mobile	11
2.1	Keys.....	11
2.2	Status bar icons	15
3	Making a call	16
3.1	Placing a call.....	16
3.2	Calling your voicemail	20
3.3	Receiving a call	21
3.4	During a call	22
4	Assistance (SOS)	23
4.1	SOS Contacts.....	23
4.2	SOS Message.....	23
5	Menu screen	24
5.1	Access main menu.....	24
5.2	Access submenu.....	25
6	Contacts	26
6.1	Consulting your contacts	26
6.2	Adding a contact.....	26
6.3	Delete a contact.....	29
6.4	Available options.....	29
7	Message	31
7.1	Write message.....	31
7.2	Read message.....	32
7.3	Settings.....	33
8	FM radio	35
9	Camera	38
9.1	Camera	38
10	Alarm	39
11	Tools	40
11.1	Calculator.....	41
11.2	Calendar.....	41
11.3	World clock	41
11.4	Notes	41
11.5	My files.....	41
11.6	Bluetooth	42
11.7	Call filter.....	42
11.8	Services	45
12	Multimedia	46
12.1	Image viewer.....	46
12.2	Audio player.....	46
12.3	Sound recorder.....	47
13	Settings	47
13.1	Phone settings.....	48
13.2	Profiles.....	48
13.3	Call settings.....	49
13.4	Connectivity	50
13.5	Security settings	50
13.6	Network settings.....	51
13.7	Assistance (SOS).....	51
13.8	Regulatory & Safety.....	51
13.9	Restore factory settings.....	51
13.10	About.....	51

14 Input mode	52
Safety and use	52
Radio waves:	60
Licences.....	64
General information.....	64
Warranty.....	67
Troubleshooting.....	70
Specifications.....	77

SAR

alcatel

This product meets applicable national SAR limits of 2.0 W/kg for head and body, and 4.0 W/kg for Limbs. The specific maximum SAR values can be found on **Radio waves** section.

When carrying the product or using it while worn on your body, either use an approved accessory such as a holster or otherwise maintain a distance of 0.5 cm from the body to ensure compliance with RF exposure requirements. Note that the product may be transmitting even if you are not making a phone call.



PROTECT YOUR HEARING

To prevent possible hearing damage, do not listen at high volume levels for long periods of time. Exercise caution when holding your phone near your ear while the loudspeaker is in use.

1 Getting started.....

1.1 Set up

Removing or installing the back cover

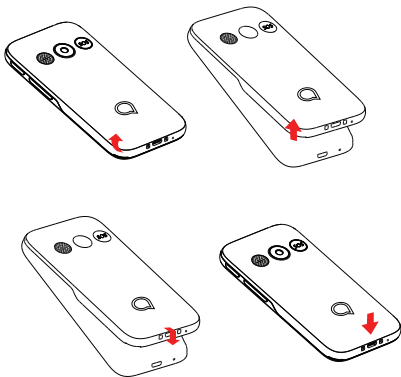

Installing or removing the battery

Insert and click the battery into place, then close the phone cover.

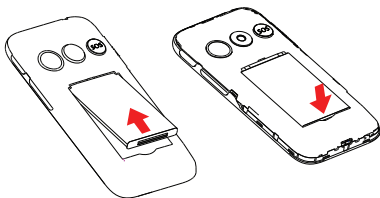

Unclip the cover, then remove the battery.

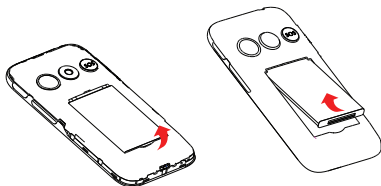

Inserting or removing the SIM card

You must insert your SIM card to make phone calls.

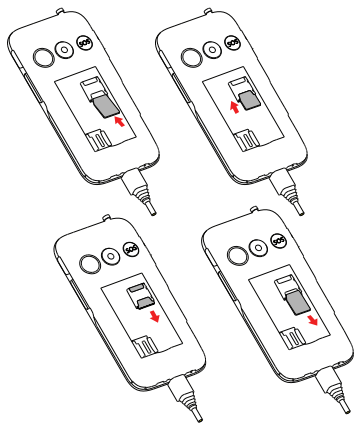

Place the SIM card with the chip facing downwards and slide it into its housing. Make sure that it is correctly inserted. To remove the card, press and slide it out.

Inserting or removing the SD card

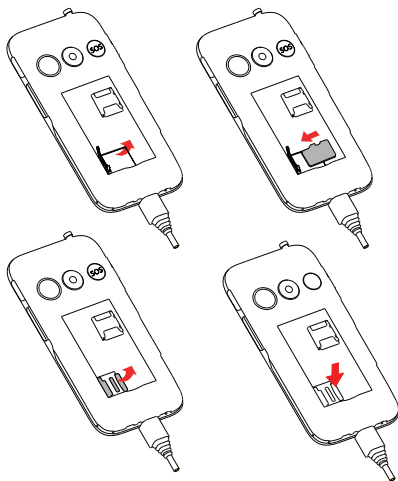

Charging the battery

The phone can be charged in the following ways:

a.

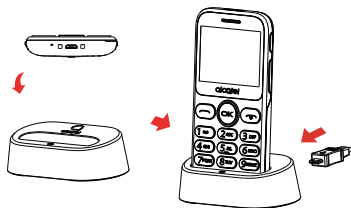

To charge the phone, you can place the cradle charging connector of the phone to the cradle, then connect battery charger to the cradle and plug into the socket.

b.

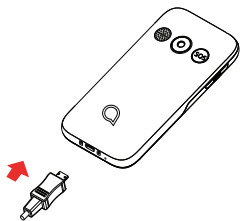

Connect battery charger to your phone and plug into the socket

- Be careful not to force the plug into the socket.
- Make sure the battery is correctly inserted before connecting the charger.
- The mains socket must be near to the phone and easily accessible (avoid electric extension cables).



To reduce power consumption and wasting energy, when battery is fully charged, disconnect your charger from the plug; reduce the backlight time, etc.

1.2 Power on your phone

Hold down the  key until the telephone powers on.

1.3 Power off your phone

Hold down the  key from the Home screen.

2 Your mobile

2.1 Keys

Headset connector



Torch



USB CONNECTOR

- 1 Menu/Direction key
- 2 Select/Call key
- 3 Back/End call key
- 4 Voicemail key

Camera

Speaker

Assistant
(SOS) key

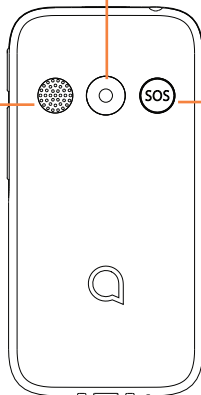

Lock key

Torch key

Volume
key

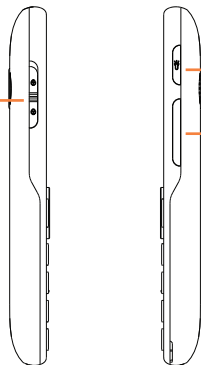



From Idle screen

- Press: Access Main menu



Call key

- Pick up/Send a call
- Press: Enter Call log (From Idle screen)



- Press: End a call
Return to the Idle screen
Delete character (In Edit mode)

- Press and hold: Power on/off



From Idle screen

- Press: 0
- Press and hold: “+/p/w”

In Edit mode

- Press: Access symbols table
- Press: 0 (when input mode is **Add numbers**)
- Press and hold: 0



From Idle screen

- Press: *

In Edit mode:

- Press: Change input methods
- Press and hold: Access input method language list













From Idle screen

- Press: #
- Press and hold: Access speed dial

In Edit mode

- Press: (space)

2.2 Status bar icons ⁽¹⁾

	Battery charge level.
	Call forwarding activated.
	Alarm or appointments programmed.
	Level of network reception.
	Roaming.
	SMS unread.
	Silence mode.
	Missed calls.
	Vibration alert.
	Headset mode.
	Bluetooth status



⁽¹⁾ The icons and illustrations in this guide are provided for informational purposes only.

G

GPRS connection status

3 Making a call.....

3.1 Placing a call

Dial the desired number then press  key to place the call. If you make a mistake, press  key to delete the incorrect digits.

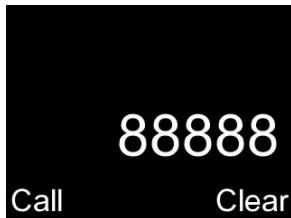

You can also make a call from your call log:

First, press  key from Idle screen to access the call log and choose the contact you want to dial, then select **Options**.

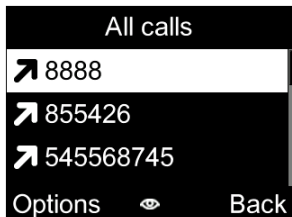

Then select **Call**.

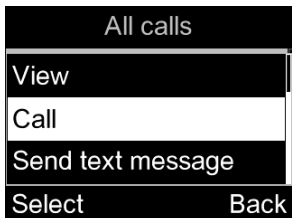

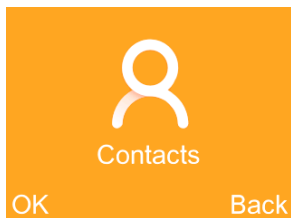

If you want to make a call from phonebook, select **Contacts\Options\Call**.

Select **Contacts** from main menu:

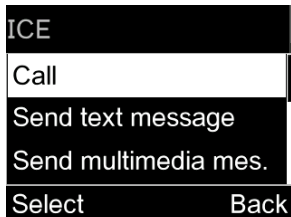
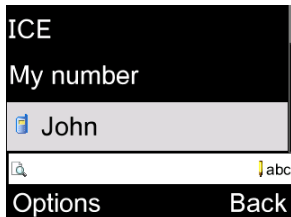

Choose the contact you want to dial, then select **Options**; finally, select **Call**.



To hang up the call, press the  key (Select **End call**).

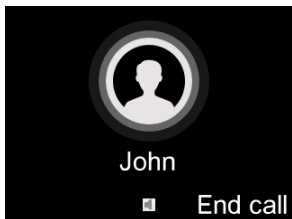

Making an emergency call

If your phone has network coverage, dial emergency number and press the send key to make an emergency call. This works even without a SIM card and without typing the PIN code.

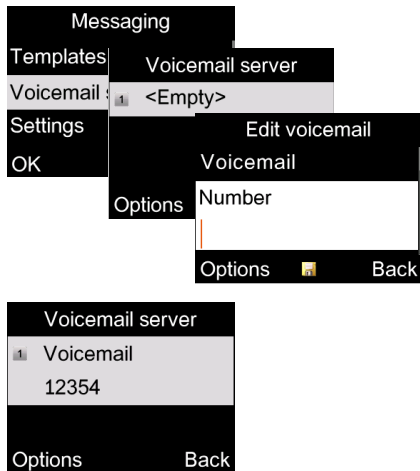

3.2 Calling your voicemail ⁽¹⁾

To access your voicemail, hold down the **1**  key. To edit your voicemail, select **Messaging\Voicemail server\Edit**, then you can edit the voicemail name and number. Finally, select **Save**.



⁽¹⁾ Contact your network operator to check service availability.

3.3 Receiving a call

When you receive an incoming call, press the  key to talk and then hang up using the  key.

Select **Answer** to pick up the call.

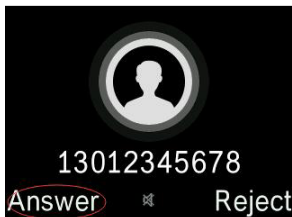

If the icon  is displayed, vibration is activated and no ringtone will play.

If the icon  is displayed, the phone neither rings nor vibrates.



The caller's number is displayed if it is transmitted by the network (contact your network operator to check service availability).

Rejecting a call

Press the  key once.

Select **Reject** to reject the call.

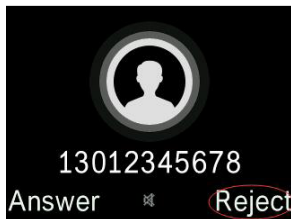

3.4 During a call ⁽¹⁾

During a call, following options are available:

- Handfree (Press Menu key)
- HAC (Hearing Aid Compatibility)

You can adjust the sound level during a call by using the up/down or side key.



Move the handset away from your ear while using the "H-free" option because the amplified volume might cause hearing damage.

Handling two calls

- Answering a second call (ensure that "Call waiting" is activated, see page 55).

⁽¹⁾ Contact your network operator to check service availability.

4 Assistance (SOS).....

4.1 SOS Contacts

To add an SOS number to your SOS contacts, select **Settings\Assistance (SOS) \Contacts list** and press **Options\Edit**, then you can edit your SOS numbers.

4.2 SOS Message

From the main menu select **Settings\Assistance (SOS)\Message** to create an SOS message.

5 Menu screen.....

5.1 Access main menu

Press  from the Idle screen to enter the main menu.

The main menu can be used to select your favourites by pressing  in the left or right direction.

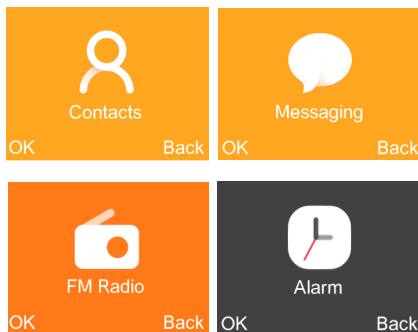

5.2 Access submenu

Access submenus in the phone by pressing

 upwards or downwards from the main menu.

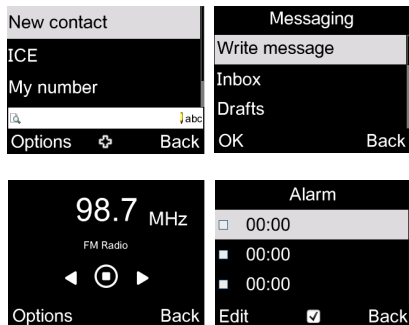

6 Contacts

6.1 Consulting your contacts

You can access this function by selecting **Contacts** from the main menu.

Searching for a contact

You can search for a contact by typing the initial of their name. Subsequent letters may be added to refine the search.

Viewing a contact

Select a name from your contacts to read the contact information.

6.2 Adding a contact

You can add a new contact to phone or SIM card by pressing **OK**, and select **New contact** to enter the "New contact" screen.

First, press  from Idle screen to access **Contacts** and select **OK**.

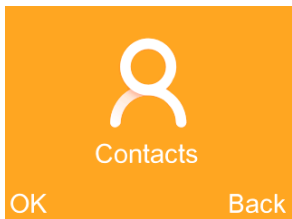

Secondly, select **New contact**.

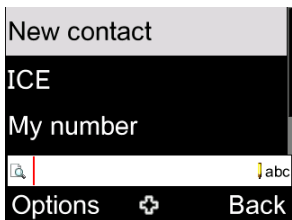

Thirdly, you can choose to add the new contact to your phone or SIM card.

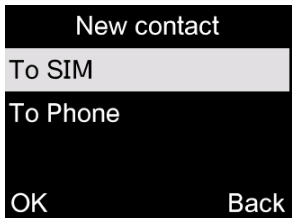

Finally, edit the name and numbers and save

them.

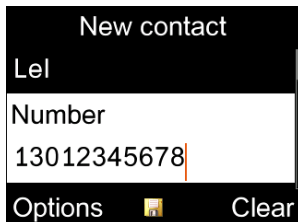
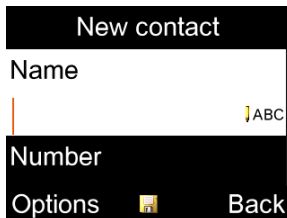

6.3 Delete a contact

Select the contact you want to delete and press  to select **Options**.

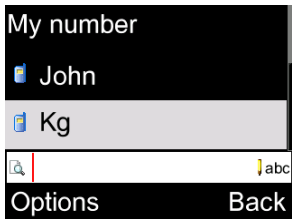

Then select **Delete** to remove the contact.

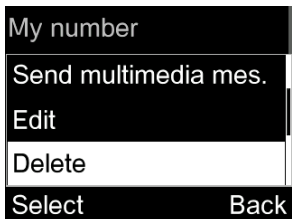

6.4 Available options

From the contact list, you can access the following options:

Call

Make a call to the selected contact.

Send a text message

Send a text message to the selected contact.

Send a multimedia message

Send a multimedia message to the selected contact.

Edit

Edit the selected contact.

Delete

Delete the selected contact.

Copy

Copy the selected contact from your phone to SIM or from your SIM to phone.

Send business card

Send the business card via SMS/MMS/Bluetooth.

Others

• Speed dial

To enable/disable speed dial and edit the speed dial number.

• Extra number

To enable/disable fixed dial and edit the fixed dial number.

• memory status

Review the memory status of your phone and SIM card.

• copy all

Copy all the contacts from phone to SIM or from SIM to phone.

• Move contacts

Move all the contacts from your phone to SIM or from your SIM to phone.

- **delete all**

Delete all the contacts from your SIM or Phone.

7 Messaging

7.1 Write messages

From the Message screen select **OK\Create message** to create a text/multimedia message.

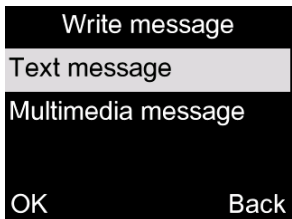
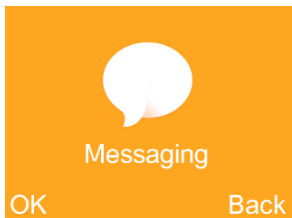

How to type a message:

You can enter text using normal or predictive text input. To set your desired text input, press *** g'** to select.

For normal text input, press a number key, 2-9, repeatedly until the desired character is displayed. If the next letter you want is located on the same key as the present one, wait until the cursor is displayed.

For predictive text input, start entering a word by using the 2-9 keys and press the key once and the word will be modified each time you press a key. As you go on, the word will keep changing.

To insert a punctuation mark or special character, press **0+** key.

If you want to delete the already typed letters or symbols press **⌫** to delete them one by one.

7.2 Read message

From the Messaging screen select **OK\Inbox** to read the text/multimedia message.

How to read a message:

If a message comes, a notification will be shown in the idle screen. Press **Read** to read it or press **Exit** to keep it unread.

If you want to view all the messages received or sent, select **Messaging\Inbox\Outbox\Sent messages**.

While writing a message, select **Options** to access all the messaging options.

You can save any messages that you often send to Drafts.

7.3 Settings

Text message

Message centre

- SMSC address

You can view and edit your SMSC address.

- Validity period

You can set your message validity period as **1 hour, 6 hours, 12 hours, 1 day, 3 days, 1 week** or **Maximum**.

- Message type

To set your message type as **Text, Fax group 3, Fax group 4, Page** or **Email**.

- Status report

Select **on/off** to enable/disable status report.

- Reply path

Select **on/off** to enable/disable reply path.

- Voicemail server

To set your voicemail.

Memory status

You can view the memory status of your SIM card and phone.

Text msg. counter

You can view the quantity of your sent /Received messages.

Save sent message

Select **On/Off** to save sent messages or not.

Preferred storage

Set the path for the location of your saved messages.

Character set

You can set the character code as **Automatic** or **7 bit**.

Multimedia message

Data account

Select your data account for multimedia messages.

Common settings

In this menu, you can set **Compose, Sending, Retrieve, Preferred storage, Memory status**.

8 FM radio⁽¹⁾

Your phone is equipped with a radio ⁽²⁾ functionality. You can use the application as a traditional radio with saved channels. You can listen to it while running other applications.

First, to turn on the radio, select **FM radio** from main menu.

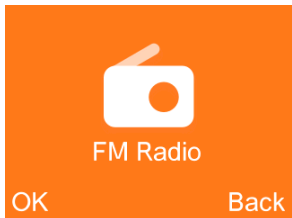

⁽¹⁾ App availability depends on country and operator.

⁽²⁾ The quality of the radio depends on the coverage of the radio station in that particular area.

Then, search the channel by selecting **OK\Options\Auto search and save** (when using this function for the first time). Stations will be automatically saved to **Channel list**, and you can select one.

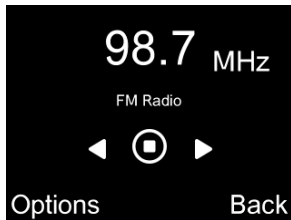

How to choose the existed channel:

a. From the FM radio main screen:

Scroll **left/right** key to change the channel.

b. From the channel list:

Select **Options\Channel list** after entering FM Radio, and choose the channel you like. You can **Play/ Edit /Delete** the selected channel.

How to add a new channel:

Select **Options \ Channel list \ <Empty> \ Edit** after entering **FM Radio**, and edit the **Channel name** and **Frequency**, then select **Save**.

Finally, to turn off the radio, press the Menu

key in the FM radio main screen.

Available options:

Channel list

Open the list of saved stations.

Manual input

manual input the channel you want to search for.

Auto search

Start auto search and stations will be automatically saved to "**Channel list**".

Settings

- Background play

Set to play the FM Play in the background.

- Audio quality

Adjust the audio quality to **Low** or **High**.

- Record storage

To set the record storage on Phone or on Memory card.

Record

Recording while playing FM.

File list

To view the recording files.

9 Camera.....

9.1 Camera

9.1.1 Take a photo, save or delete

The screen acts as the viewfinder. Position the object or landscape in the viewfinder and press  to take the image and the images will be automatically saved. If you don't want it, you may directly delete it.

9.1.2 Settings in framing mode

Before taking the photo, you can adjust a number of settings:

Photos

- View the images you have taken.

Camera settings

- Set **Anti-flicker**, **Scene mode**, **White balance**, **Delay timer**.

Image settings

- Set **Image size** and **Image quality**.

Storage

- Select **Phone** or **Memory card** to store the files.

9.1.3 Options available after taking the photo

Once you have taken a photo, you can go to "Multimedia" to view it, send it by Bluetooth

or MMS, or set it as a wallpaper.

10 Alarm.....

Your mobile phone has a built-in alarm clock with a snooze feature. You can set up your alarm by selecting **Alarm\OK\Edit** from main menu.

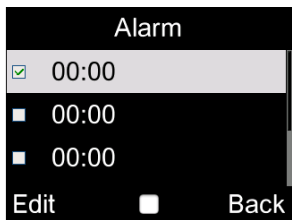
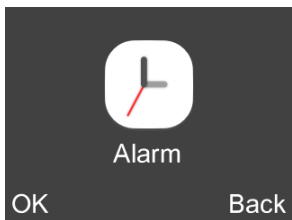

- You can set up your time when you access above Alarm screen, select **Edit** to set the name, time, ringtone, snooze, repeat.

Time

You can set the alarm time.

Snooze

The alarm will repeat at regular intervals.

Repeat

Select Once (default)/Daily/Working days as your preference.

Alarm tone

You can choose one tone as the alarm ringtone.

11 Tools.....

When you enter this menu, press **OK** to select your preferences in the following features: **Calculator, Calendar, World clock, Notes, My Files, Bluetooth, Call filter, Services.**

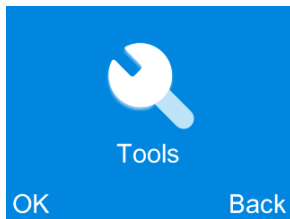

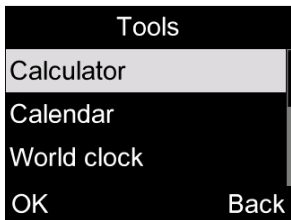

11.1 Calculator

Enter a number, select the type of operation and enter the second number, press **Equal** to display the result.

11.2 Calendar

Once you enter this menu, there is a monthly-view calendar for you to check date.

11.3 World clock

The first clock displays the time based on your location when you set up your phone. You can add other cities to show the time in their time zones.

11.4 Notes

You can add texts that need to be recorded.

11.5 My files

You will have access to all audio and visual files stored in phone or Memory card in My files.

11.6 Bluetooth

You can activate/deactivate the Bluetooth, check device list, edit phone's name, etc.

11.7 Call filter

You can create Blacklist and Whitelist through this function.

From **Call filter** phone screen, the following options are available:

Blacklist

You can add contacts to the blacklist mainly from the following ways:

1. Create a new one

From **Blacklist**, press **OK key** to create a new one.

- Enter a name and number.

- **Options > Save**

2. From Contacts

Blacklist > press **Call key** to select **From > Contacts**

- Select one contact from the **Contacts** list at a time.

- **Add to Blacklist? > Yes > Options > Save**

3. From Call Logs

Blacklist > press **Call key** to select **From** > **Call Logs**

- Select a contact or number from **All calls** in **Call logs**

- **Add to Blacklist?** > **Yes** > **Options** > **Save**

4. From **Messaging**

Blacklist > press **Call key** to select **From** > **Messaging**

- Select a message from **Inbox**

- **Add to Blacklist?** > **Yes** > **Options** > **Save**

Whitelist

You can add contacts to the whitelist mainly from the following ways:

1. Create a new one

From **Whitelist**, press **OK key** to create a new one.

- Enter a name and number.

- **Options** > **Save**

2. From **Contacts**

Whitelist numbers > press **Call key** to select **From** > **Contacts**

- Select one contact from the **Contacts** list at a time.

- **Add to Whitelist?** > **Yes** > **Options** > **Save**

3. From **Call Logs**

Whitelist > press **Call key** to select **From** > **Call Logs**

- Select a contact or number from **All calls** in **Call logs**

- **Add to Whitelist?** > **Yes** > **Options** > **Save**

4. From **Messaging**

Whitelist > press **Call key** to select **From** > **Messaging**

- Select a message from **Inbox**

- **Add to Whitelist?** > **Yes** > **Options** > **Save**

Settings

You are allowed to select from the following options:

1. Enable Blacklist

Enable the blacklist to automatically block all callers listed on the blacklist.

2. Enable Whitelist

Enabling the whitelist will only allow callers listed on the whitelist.

3. Disable Call filter

Disabling both blacklist and whitelist will allow any callers.

Note: Enabling both the blacklist and whitelist will only allow callers from the numbers listed on the whitelist. If there is no number in the whitelist, the phone will not allow any callers.

11.8 Services

STK service is the tool kit of SIM card. This phone supports the service function. The specific items depend on SIM card and network. Service menu will be automatically added to the phone menu when supported by network and SIM card. Note: Consult the local network operator for related fee and specific setup.

12 Multimedia.....

When you enter this menu, press **OK key** to select your preferences in the following features: **Image viewer, Audio player, Sound recorder.**

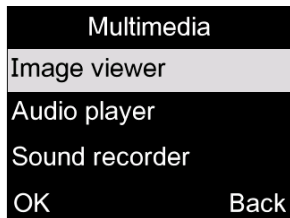
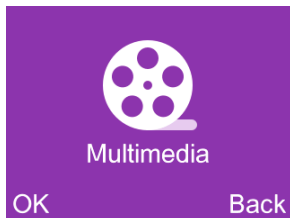

12.1 Image viewer

You can view images with this function.

12.2 Audio player

You can play the songs you prefer in the list.

12.3 Sound recorder

Use this function to record audio files. The phone support AMR and WAV. The recording file you stopped will be stored in audio file automatically.

13 Settings.....

From the main menu, select **Settings\OK** and access the function of your choice in order to customise your telephone.

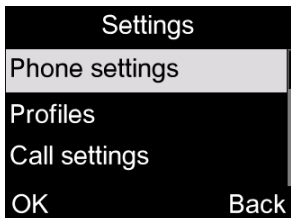
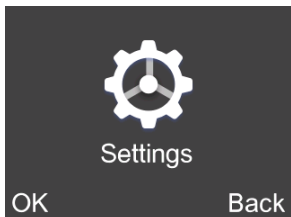

13.1 Phone settings

To modify the phone settings, select **Phone settings** to reveal the following options: **Display, Time and date, Language, Pref. input method, Schedule power on/off.**

Display

This function allows you to set **Wallpaper**, adjust **LCD backlight**, **Keypad backlight**, and to turn on/off **Show date and time.**

Time and date

This allows you to modify date and time settings, including **Set home city, Set time/date, Set format.** You can also select On/Off to activate or deactivate **Update with time zone** and **Auto update time.**

Language

Choose the display language for messages here.

Pref. input method

Choose the input language in this menu.

Schedule power on/off

You can set the Schedule power on/off times using this function.

13.2 Profiles

With this menu, you can set the sound mode to **General, Silent, Meeting or Flight mode.**

13.3 Call settings

Caller ID

You can select **Set by network**, **Hide ID** or **Send ID**.

Call waiting

Activate/Deactivate the notification of a second incoming call by a beep. You can also query the status of waiting calls.

Call divert

You can activate, deactivate or query the status of call forwarding to voicemail or to a specified number. The following configurations are possible:

Divert all voice calls, **Divert if unreachable**, **Divert if no answer**, **Divert if busy**, **Divert all data calls**, **Cancel all divers.**

Call barring

The following configurations are possible:

Outgoing calls

All outgoing calls are barred.

Incoming calls

All incoming calls are barred.

Cancel all

Deactivate all call barring.

Change barring password

Change the original barring password for activating call barring.

Advanced settings

You can set **Auto redial**, **Call time reminder**, **Connect notice** and **Answer mode**.

13.4 Connectivity

You can access this feature to set and select your preferred data accounts.

13.5 Security settings

SIM Security

- **PIN lock**

You can protect your SIM security by inputting a PIN. The default setting is 1234.

- **Change PIN**

PIN lock must be enabled.

- **Change PIN2**

A protection code for certain SIM card features (FDN) will be requested if you attempt to access the card when the code is activated. Select to update it with a new one (between 4 and 8 digits).

Phone Security

- **Phone lock**

You can protect your phone security by inputting a phone password. The default setting is 0000.

- **Change password**

Change the phone's password.

13.6 Network settings

Network selection

Network connection can be switched between **Automatic** and **Manual**.

GPRS connection

GPRS connection can be switched between **When needed** and **Always**.

13.7 Assistance (SOS)

Refer to "Assistance (SOS)", page 23.

13.8 Regulatory & Safety

View your phone information, such as **Product model**, **Manufacturer name**, **IMEI**, **CU Reference**, etc.

13.9 Restore settings

Make the phone's settings recover to its default value. End-user data will not be erased. Enter its default password 0000 to confirm to restore and reboot.

13.10 About

Refer to the Privacy and User terms in this menu

14 Input mode.....

This mode allows you to type a text by choosing a letter or a sequence of characters associated with a key. Press the key several times until the desired letter is highlighted. When you release the key the highlight character is inserted into the text.

Safety and use

We recommend that you read this chapter carefully before using your phone. The manufacturer disclaims any liability for damage, which may result as a consequence of improper use or use contrary to the instructions contained herein.

● **TRAFFIC SAFETY:**

Given that studies show that using a mobile phone while driving a vehicle constitutes a real risk, even when the hands-free kit is used (car kit, headset...), drivers are requested to refrain from using their mobile when the vehicle is not parked.

When driving, do not use your phone and headphone to listen to music or to the radio. Using a headphone can be dangerous and forbidden in some areas.

When switched on, your phone emits electromagnetic waves that can interfere with the vehicle's electronic systems such as ABS anti-lock brakes or airbags. To ensure

that there is no problem:

- do not place your phone on top of the dashboard or within an airbag deployment area,
- check with your car dealer or the car manufacturer to make sure that the dashboard is adequately shielded from mobile phone RF energy.

● **CONDITIONS OF USE:**

You are advised to switch off the telephone from time to time to optimise its performance. Switch the phone off before boarding an aircraft.

Switch the phone off when you are in health care facilities, except in designated areas. As with many other types of equipment now in regular use, mobile telephones can interfere with other electrical or electronic devices, or equipment using radio frequency.

Switch the phone off when you are near gas or flammable liquids. Strictly obey all signs and instructions posted in a fuel depot, petrol station, or chemical plant, or in any potentially explosive atmosphere.

When the phone is switched on, it should be kept at least 15 cm from any medical device such as a pacemaker, a hearing aid or insulin pump, etc. In particular when using the phone, you should hold it against the ear on the opposite side to the device, if any.

To avoid hearing impairment, pick up the call before holding your phone to your ear. Also move the handset away from your ear while

using the "hands-free" mode because the amplified volume might cause hearing damage. Do not let children use the phone and/or play with the telephone and accessories without supervision.

When replacing the cover please note that your phone may contain substances that could create an allergic reaction.

Always handle your phone with care and keep it in a clean and dust-free place.

Do not allow your phone to be exposed to adverse weather or environmental conditions (moisture, humidity, rain, infiltration of liquids, dust, sea air, etc). The manufacturer's recommended operating temperature range is 0°C (32°F) to +40°C (104°F).

At over 40°C (104°F) the legibility of the phone's display may be impaired, though this is temporary and not serious.

Emergency call numbers may not be reachable on all mobile networks. You should never rely only on your phone for emergency calls.

Do not open, dismantle or attempt to repair your mobile phone yourself.

Do not drop, throw or bend your mobile phone.

Do not use the phone if the glass made screen, is damaged, cracked or broken to avoid any injury.

Do not paint it.

Use only batteries, battery chargers, and accessories which are recommended by TCL Communication Ltd and its affiliates and

are compatible with your phone model. TCL Communication Ltd and its affiliates disclaim any liability for damage caused by the use of other chargers or batteries.

Remember to make back-up copies or keep a written record of all important information stored in your phone.

Some people may suffer epileptic seizures or blackouts when exposed to flashing lights, or when playing video games. These seizures or blackouts may occur even if a person never had a previous seizure or blackout. If you have experienced seizures or blackouts, or if you have a family history of such occurrences, please consult your doctor before playing video games on your phone or enabling a flashing-lights feature on your phone.

Parents should monitor their children's use of video games or other features that incorporate flashing lights on the phones. All persons should discontinue use and consult a doctor if any of the following symptoms occur: convulsion, eye or muscle twitching, loss of awareness, involuntary movements, or disorientation. To limit the likelihood of such symptoms, please take the following safety precautions:

- Do not play or use flashing-light features if you are tired or need sleep.
- Take a minimum 15-minute break hourly.
- Play in a room in which all lights are on.
- Play at the farthest distance possible from the screen.

- If your hands, wrists, or arms become tired or sore while playing, stop and rest for several hours before playing again.
- If you continue to have sore hands, wrists, or arms during or after playing, stop the game and see a doctor.

When you play games on your phone, you may experience occasional discomfort in your hands, arms, shoulders, neck, or other parts of your body. Follow the instructions to avoid problems such as tendinitis, carpal tunnel syndrome, or other musculoskeletal disorders.



PROTECT YOUR HEARING

To prevent possible hearing damage, do not listen at high volume levels for long periods. Exercise caution when holding your device near your ear while the loudspeaker is in use.

● PRIVACY:

Please note that you must respect the laws and regulations in force in your jurisdiction or other jurisdiction(s) where you will use your mobile phone regarding taking photographs and recording sounds with your mobile telephone. Pursuant to such laws and regulations, it may be strictly forbidden to take photographs and/or to record the voices of other people or any of their personal attributes, and duplicate or distribute them, as this may be considered to be an invasion of privacy. It is the user's sole responsibility to ensure that

prior authorisation be obtained, if necessary, in order to record private or confidential conversations or take a photograph of another person; the manufacturer, the seller or vendor of your mobile phone (including the operator) disclaim any liability which may result from the improper use of the mobile phone.

● **BATTERY:**

Following air regulation, the battery of your product is not charged. Please charge it first. Before removing the battery from your phone, please make sure that the phone is switched off.

Observe the following precautions for battery use:

- Do not attempt to open the battery (due to the risk of toxic fumes and burns).
- Do not puncture, disassemble or cause a short-circuit in a battery,
- Do not burn or dispose of a used battery in household rubbish or store it at temperatures above 60°C.

Batteries must be disposed of in accordance with locally applicable environmental regulations. Only use the battery for the purpose for which it was designed. Never use damaged batteries or those not recommended by TCL Communication Ltd and/or its affiliates.



This symbol on your telephone, the battery and the accessories means that these phones must be taken to collection points at the end of their life:

- Municipal waste disposal centres with specific bins for these items of equipment
- Collection bins at points of sale.

They will then be recycled, preventing substances being disposed of in the environment, so that their components can be reused.

In European Union countries:

These collection points are accessible free of charge.

All phones with this sign must be brought to these collection points.

In non European Union jurisdictions:

Items of equipment with this symbol are not to be thrown into ordinary bins if your jurisdiction or your region has suitable recycling and collection facilities; instead they are to be taken to collection points for them to be recycled.

CAUTION: RISK OF EXPLOSION IF BATTERY IS REPLACED BY AN INCORRECT TYPE. DISPOSE OF USED BATTERIES ACCORDING TO THE INSTRUCTIONS

• CHARGERS

Mains powered chargers will operate within the temperature range of: 0°C (32°F) to 40°C (104°F).

The chargers designed for your phone meet the standard for safety of information technology equipment and office equipment use. They are also compliant with the ecodesign directive 2009/125/EC. Due to different applicable electrical specifications, a charger you purchased in one jurisdiction may not work in another jurisdiction. They should be used for this purpose only.

Model: PA-5V550mA-006/
PA-5V550mA-015/PA-5V550mA-026

Input Voltage: 100~240V

Input AC Frequency: 50/60Hz

Output Voltage: 5.0V

Output Current: 0.55A

Output Power: 2.75 W

Average active efficiency: 69.0%

No-load power consumption: 0.08 W

Model: UC11

Input Voltage: 100~240V

Input AC Frequency: 50/60Hz

Output Voltage: 5.0V

Output Current: 1.0A

Output Power: 5.0 W

Average active efficiency: 73.8%

No-load power consumption: 0.08 W

Radio waves :

Proof of compliance with international standards (ICNIRP) or with European Directive 2014/53/EU (RED) is required of all mobile phone models before they can be put on the market. The protection of the health and safety for the user and any other person is an essential requirement of these standards or this directive.

THIS DEVICE MEETS INTERNATIONAL GUIDELINES FOR EXPOSURE TO RADIO WAVES.

Your mobile device is a radio transmitter and receiver. It is designed not to exceed the limits for exposure to radio waves (radio frequency electromagnetic fields) recommended by international guidelines. The guidelines were developed by an independent scientific organisation (ICNIRP) and include a substantial safety margin designed to assure the safety of all persons, regardless of age and health.

The radio wave exposure guidelines use a unit of measurement known as the Specific Absorption Rate, or SAR. The SAR limit for mobile devices is 2 W/kg for Head SAR and Body-worn SAR, and 4 W/kg for Limb SAR.

Tests for SAR are conducted using standard operating positions with the device transmitting at its highest certified power level in all tested frequency bands. The highest SAR values under the ICNIRP guidelines for

this device model are:

Maximum SAR for this model and conditions under which it was recorded.		
Head SAR	GSM 900	0.84 W/kg
Body-worn SAR (5 mm)	GSM 1800	1.63 W/kg
Limb SAR (0 mm)	GSM 1800	1.63 W/kg

During use, the actual SAR values for this device are usually well below the values stated above. This is because, for purposes of system efficiency and to minimize interference on the network, the operating power of your mobile device is automatically decreased when full power is not needed for the call. The lower the power output of the device, the lower its SAR value.

Body-worn SAR testing has been carried out at a separation distance of 5 mm. To meet RF exposure guidelines during body-worn operation, the device should be positioned at least this distance away from the body. If you are not using an approved accessory ensure that whatever product is used is free of any metal and that it positions the phone the indicated distance away from the body.

Organisation such as the World Health Organisation and the US Food and Drug Administration have stated that if people are concerned and want to reduce their exposure they could use a hands-free device to keep

the phone away from the head and body during phone calls, or reduce the amount of time spent on the phone.

For more information you can go to www.alcatelmobile.com

Additional information about electromagnetic fields and public health are available on the following site: <http://www.who.int/peh-emf>.

Your telephone is equipped with a built-in antenna. For optimal operation, you should avoid touching it or degrading it.

As mobile devices offer a range of functions, they can be used in positions other than against your ear. In such circumstances the device will be compliant with the guidelines when used with headset or usb data cable. If you are using another accessory ensure that whatever product is used is free of any metal and that it positions the phone at least 5 mm away from the body.

Your product can store personal information in various locations including a SIM card, memory card, and built-in memory. Be sure to remove or clear all personal information before you recycle, return, or give away your product. Choose your apps and updates carefully, and install from trusted sources only. Some apps can impact your product's performance and/or have access to private information including account details, call data, location details and network resources.

Note that any data shared with TCL Communication Ltd. is stored in accordance with applicable data protection legislation. For these purposes TCL Communication Ltd. implements and maintains appropriate technical and organizational measures to protect all personal data, for example against unauthorised or unlawful processing and accidental loss or destruction of or damage to such personal data whereby the measures shall provide a level of security that is appropriate having regard to

- (i) the technical possibilities available,
- (ii) the costs for implementing the measures,
- (iii) the risks involved with the processing of the personal data, and
- (iv) the sensitivity of the personal data processed.

You can access, review and edit your personal information at any time by logging into your user account, visiting your user profile or by contacting us directly. Should you require us to edit or delete your personal data, we may ask you to provide us with evidence of your identity before we can act on your request.

Licences



microSD Logo is a trademark.



The Bluetooth word mark and logos are owned by the Bluetooth SIG, Inc. and any use of such marks by TCL Communication Ltd. and its affiliates is under licence. Other trademarks and trade names are those of their respective owners.

Alcatel 2020X Bluetooth
Declaration ID D049911

General information.....

- **Internet address:** www.alcatelmobile.com
- **Hot Line Number:** see "TCL Communication Services" leaflet or go to our Internet site.
- **Manufacturer:** TCL Communication Ltd.
- **Address:** 5/F, Building 22E, 22 Science Park East Avenue, Hong Kong Science Park, Shatin, NT, Hong Kong.

On our Internet site, you will find our FAQ (Frequently Asked Questions) section. You can also contact us by e-mail to ask any questions you may have.

This radio equipment operates with the following frequency bands and maximum radio-frequency power:

GSM 850/900: 33.5 dBm

GSM 1800/1900: 30.8 dBm

Bluetooth: 8.3 dBm

• **Regulatory information**

Hereby, TCL Communication Ltd. declares that the radio equipment type **Alcatel 2020X** is in compliance with Directive 2014/53/EU.

The full text of the EU declaration of conformity is available at the following internet address: http://www.alcatelmobile.com/EU_doc.

• **Additional information**

The description of accessories and components, including software, which allow the radio equipment to operate as intended, can be obtained in the full text of the EU declaration of conformity at the following internet address: http://www.alcatelmobile.com/EU_doc

Protection against theft ⁽¹⁾

Your telephone is identified by an IMEI (phone serial number) shown on the packaging label and in the phone's memory. We recommend that you note the number the first time you use your telephone by entering *#06# and keep it in a safe place. It may be requested by the police or your operator if your telephone is stolen. This number allows your mobile telephone to be blocked

⁽¹⁾ Contact your network operator for service availability.

preventing a third person from using it, even with a different SIM card.

Disclaimer

There may be certain differences between the user manual description and the phone's operation, depending on the software release of your telephone or specific operator services.

TCL Communication Ltd shall not be held legally responsible for such differences, if any, nor for their potential consequences, which responsibility shall be borne by the operator exclusively.

Warranty.....

Your phone is warranted against any defect or malfunctioning which may occur in conditions of normal use during the warranty period of twelve (12) months ⁽¹⁾ from the date of purchase as shown on your original invoice.

Batteries ⁽²⁾ and accessories sold with your phone are also warranted against any defect which may occur during the first six (6) months ⁽¹⁾ from the date of purchase as shown on your original invoice.

In case of any defect of your phone which prevents you from normal use thereof, you must immediately inform your vendor and present your phone with your proof of purchase.

If the defect is confirmed, your phone or part

⁽¹⁾ The warranty period may vary depending on your country.

⁽²⁾ The life of a rechargeable mobile phone battery in terms of conversation time, standby time, and total service life, will depend on the conditions of use and network configuration. Batteries being considered expendable supplies, the specifications state that you should obtain optimal performance for your phone during the first six months after purchase and for approximately 200 more recharges.

thereof will be either replaced or repaired, as appropriate. Repaired Phone and accessories are entitled to a one (1) month warranty for the same defect. Repair or replacement may be carried out using reconditioned components offering equivalent functionality.

This warranty covers the cost of parts and labor but excludes any other costs.

This warranty shall not apply to defects to your phone and/or accessory due to (without any limitation):

- 1) Non-compliance with the instructions for use or installation, or with technical and safety standards applicable in the geographical area where your phone is used,
- 2) Connection to any equipment not supplied or not recommended by TCL Communication Ltd,
- 3) Modification or repair performed by individuals not authorised by TCL Communication Ltd or its affiliates or your vendor,
- 4) Modification, adjustment or alteration of software or hardware performed by individuals not authorised by TCL Communication Ltd,
- 5) Inclement weather, lightning, fire, humidity, infiltration of liquids or foods, chemical phones, download of files, crash, high voltage, corrosion, oxidation...

Your phone will not be repaired in case labels

or serial numbers (IMEI) have been removed or altered.

There are no express warranties, whether written, oral or implied, other than this printed limited warranty or the mandatory warranty provided by your country or jurisdiction.

In no event shall TCL Communication Ltd or any of its affiliates be liable for indirect, incidental or consequential damages of any nature whatsoever, including but not limited commercial or financial loss or damage, loss of data or loss of image to the full extent those damages can be disclaimed by law.

Some countries/states do not allow the exclusion or limitation of indirect, incidental or consequential damages, or limitation of the duration of implied warranties, so the preceding limitations or exclusions may not apply to you.

Troubleshooting

Before contacting the service centre, you are advised to follow the instructions below:

- You are advised to fully charge () the battery for optimal operation.
- Avoid storing large amounts of data in your phone as this may affect its performance.
- Use User Data Format to perform phone formatting or software upgrading, (to reset User Data format, enter in *#336699*# followed by 0000). ALL User phone data: contacts, photos, messages and files will be lost permanently.

and carry out the following checks:

My phone is frozen or can't switch on

- Check the battery contacts, remove and reinstall your battery, then turn your phone on
- Check the battery power level, charge for at least 20 minutes
- If it still does not work, please use User Data Format to reset the phone.

My phone has not responded for several minutes

- Restart your phone by pressing and holding the  key
- Remove the battery and re-insert it, then restart the phone

- If it still does not work, please use User Data Format to reset the phone.

My phone turns off by itself

- Check whether your phone is locked when not in use, and make sure you don't accidentally turn off your phone when locking it by pressing the power key
- Check the battery charge level
- If it still does not work, please use User Data Format to reset the phone.

My phone can't charge properly

- Make sure you are using an alcatel battery and the charger from the box
- Make sure your battery is inserted properly and clean the battery contact if it's dirty. It must be inserted before plugging in the charger
- Make sure that your battery is not completely discharged; if the battery power is empty for a long time, it may take around 20 minutes to display the battery charger indicator on the screen.
- Make sure charging is carried out under normal conditions (0°C to +40°C)
- When abroad, check that the voltage input is compatible

My phone can't connect to a network or "No service" is displayed

- Try connecting in another location

- Verify the network coverage with your operator
- Check with your operator that your SIM card is valid
- Try selecting the available network(s) manually
- Try connecting at a later time if the network is overloaded

Invalid SIM card

- Make sure the SIM card has been correctly inserted
- Make sure the chip on your SIM card is not damaged or scratched
- Make sure the service of your SIM card is available

Unable to make outgoing calls

- Make sure you have dialed a valid number and press the send key
- For international calls, check the country and area codes
- Make sure your phone is connected to a network, and the network is not overloaded or unavailable
- Check your subscription status with your operator (credit, SIM card valid, etc.)
- Make sure you have not barred outgoing calls
- Make sure that your phone is not in flight mode

Unable to receive incoming calls

- Make sure your phone is switched on and connected to a network (check for overloaded or unavailable network)
- Check your subscription status with your operator (credit, SIM card valid, etc.)
- Make sure you have not forwarded incoming calls
- Make sure that you have not barred certain calls
- Make sure that your phone is not in flight mode

The caller's name/number does not appear when a call is received

- Check that you have subscribed to this service with your operator
- Your caller has concealed his/her name or number

I can't find my contacts

- Make sure your SIM card is not broken
- Make sure your SIM card is inserted properly
- Import all contacts stored in SIM card to phone

The sound quality of the calls is poor

- You can adjust the volume during a call by pressing the navigation key
- Check the network strength 

- Make sure that the receiver, connector or speaker on your phone is clean

I am unable to use the features described in the manual

- Check with your operator to make sure that your subscription includes this service
- Make sure this feature does not require an alcatel accessory

When I select a number from my contacts, the number can't be dialed

- Make sure that you have correctly recorded the number in your file
- Make sure that you have selected the country prefix when calling a foreign country

I am unable to add a contact in my contacts

- Make sure that your SIM card contacts are not full; delete some files or save the files in the phone contacts

My callers are unable to leave messages on my voicemail

- Contact your network operator to check service availability

I can't access my voicemail

- Make sure your operator's voicemail number is correctly entered in "Message\Voicemail server"
- Try later if the network is busy

The flickering icon is displayed on my standby screen

- You have saved too many short messages on your SIM card; delete some of them or archive them in the phone memory

SIM card PIN locked

- Contact your network operator to obtain the PUK code (Personal Unblocking Key)

How to make your battery last longer

- Make sure you follow the complete charge time (minimum 3 hours)
- After a partial charge, the battery level indicator may not be exact. Wait for at least 20 minutes after removing the charger to obtain an exact indication
- Switch on the backlight upon request

I am unable to send and receive MMS

- Check your phone memory availability as it might be full
- Contact your network operator to check service availability and check MMS parameters
- Verify the server centre number or your MMS profile with your operator
- The server centre may be swamped, try again later

The phone can't be detected by others via Bluetooth

- Make sure that Bluetooth is turned on and your phone is visible to other users
- Make sure that the two phones are within Bluetooth's detection range

Specifications.....

Processor	ARM7+, 360MHz
Platform	MTK6261A
Memory	16MB ROM + 4MB RAM
Dimensions (LxWxT)	116.8x58.5x12.5 mm
Weight	< 80g
Display	2.4 inch main LCD screen
Network	GSM 850/900/1800/1900 (Band frequency and data speed are operator dependent.)

Connectivity	<ul style="list-style-type: none">• Bluetooth 3.0• 3.5 mm audio jack• micro-USB
Camera	0.3MP
Audio supported formats	Audio: MID, AMR, MP3(optional) Video: 3GP, MP4 (optional)
Battery ⁽¹⁾	Capacity: 970 mAh
Expansion Slot	microSD™ memory card (Availability of microSD card depends on market)

Note: Specifications are subject to change without prior notice.